



TECNOSERVICE'21 srl

by Tinti Sergio
Via Carlo Pisacane, 134
61032 Fano (PU) Italy
P.IVA IT0200411413

Tel. +39 0721 805911
FAX +39 0721 809794
e-mail: staff@technochef.it
www.technochef.it
www.technochef.eu

Services and Technologies for professional catering since 1973



CODE	DESCRIPTION	PRICE/DELIVERY
SI-IP20MAN	Manual stainless steel meat mixer, bowl capacity 20 kg, removable stainless steel blade, 2 mixing speeds, weight 13 kg, dim.mm.400x340x403h	€ 668,13 <i>VAT excluded</i> Shipping to be calculated Delivery from 8 to 15 days

PROFESSIONAL DESCRIPTION

MANUAL STAINLESS STEEL MEAT MIXER with 20 Kg BATHTUB, ideal for SMALL DOUGH, both in BUTCHER and CATERING :

- **Construction in Aisi 304 stainless steel ;**
- **Aisi 304 stainless steel shovel easily removable** without tools;
- **Reducer with hardened and ground gears ;**
- **Gear protection system** with double oil seal;
- **2 mixing speeds :**
 - 1:1 in direct drive with the shovel
 - 1:3 for tougher doughs.
- **Practical and compact .**

TECHNICAL DATA :

- Bowl dimensions: 270x300 mm
- Capacity: 28 lt / 20 kg
- Net weight: 13 kg
- Dimensions: 400x340x403mm

CE mark
Made in Italy

TECHNICAL CARD

net weight (Kg)	13
breadth (mm)	400
depth (mm)	340
height (mm)	403





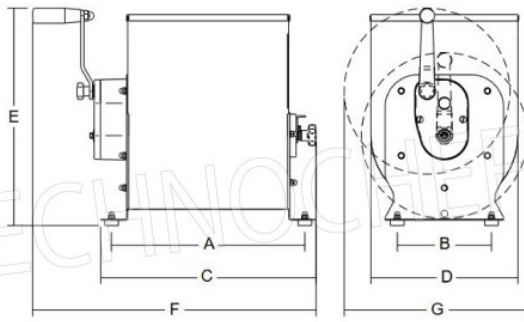

			A	B	C	D	E	F	G		
	mm	litro	mm	mm	mm	mm	mm	mm	mm	kg	kg
IP 20 Man	270-300	28/20	360	175	400	273	403	527	340	13	23