



TECNOSERVICE'21 srl

by Tinti Sergio
Via Carlo Pisacane, 134
61032 Fano (PU) Italy
P.IVA IT0200411413

Tel. +39 0721 805911
FAX +39 0721 809794
e-mail: staff@technochef.it
www.technochef.it
www.technochef.eu

Services and Technologies for professional catering since 1973



CODE	DESCRIPTION	PRICE/DELIVERY
BS-G7F6+FE	GAS COOKER 6 BURNERS on ELECTRIC OVEN GN 2/1, BERTOS, MACROS 700 line, HIGH POWER series, thermal power 31.5 kW + electrical power 7.5 kW, weight 126 kg, dim.mm.1200x700x900h	

PROFESSIONAL DESCRIPTION

GAS COOKER 6 BURNERS on ELECTRIC OVEN GN 2/1, MACROS 700 line, HIGH POWER series :

- **worktop and front panels in AISI 304 stainless steel ;**
- high power single and double crown **burners guaranteed for life entirely in nickel-plated cast iron** operated by a valved tap with **safety thermocouple** and **pilot light** ;
- **cast iron grills ;**
- removable trays for maximum hygiene and easy maintenance;
- **80 mm burners entirely in cast iron** , with regulation up to 3.5 kW, **and 110 mm** , with regulation up to 7 kW;
- **open fire power n°x kW : 3 x 3.5 kW + 3 x 7 kW ;**
- **static electric oven entirely made of stainless steel** , with **4-level supports for GN 2/1 grids/trays** (530x650 mm);
- **Grill with salamander function** in the upper part and thermostat that allows accurate **temperature regulation from 50 to 270 °C** ;
- **line indicator** and **temperature indicator** ;
- **door and inner door pressed in AISI 304 stainless steel** ;
- **high-resistance door handle in 20/10 thick AISI 304 steel** ;
- adjustable feet;
- **2 year warranty .**

Supplied :

- 1 anti-tipping oven rack

Accessories/Options:

- compartment door

CE mark

Made in Italy

TECHNICAL CARD

power supply | Monofase

Volts	V 230/1
frequency (Hz)	50
Thermal input (Kw)	31,5
net weight (Kg)	126
gross weight (Kg)	141
breadth (mm)	1200
depth (mm)	700
height (mm)	900



MACROS 700

highpower



n.	3	3
Ø mm	80	110
kW	3,5	7
kcal/h	3.010	6.020
Btu/h	11.942	23.884



GN	2/1
mm	530 x 650 x 4 pos.
TOT. kW	7,5 (4,5+3)



TOT. kW	31,5
kcal/h	27.090
TOT. Btu/h	107.478



G30/G31	kg/h	2,48
G20	m³/h	3,33
G25	m³/h	3,88

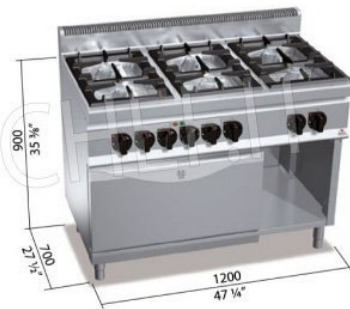

MACROS 700

highpower

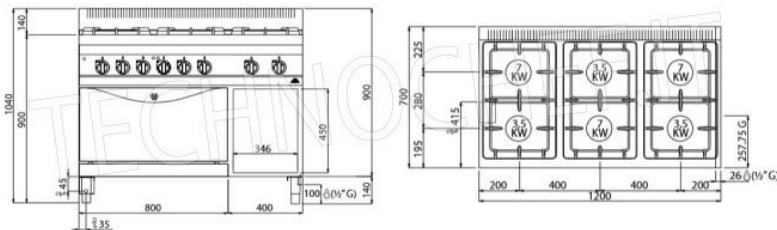

Macros 700

HIGH POWER



3,5 kW

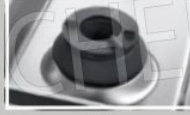

7 kW